

Type	S4-J 4-pole, 2 connection level Logic wiring Integrated retaining clip and labelling space
-------------	--

Rated current	10 A
----------------------	-------------

Specifications

Rated load	10 A / 250 V
Insulation	Test voltage V rms / 1 min
– All terminals/DIN rail	2,5 kV
– Terminal/terminal	2,5 kV
Cross-section of connecting wire	
– Single-wire	4 mm ² or 2 x 2,5 mm ²
– Multi-wire	22 - 14 AWG
Max. screw torque	1,2 Nm
Screw dimensions	M3,5, Philips-slot (combo)
Integrated retaining clip/plastic	for relay series C4
Labelling space	detachable
Connection label	1...14; DIN/EN
Mounting	DIN rail TS35 or mounting plate
Ambient temperature	-40 (no ice)...60 °C / -40 ... 80 °C

Associated, plug-in 11-pin MRC relays	C4-A, C4-X, C4-R
--	-------------------------

Accessories

Retaining spring, steel	S4-C
-------------------------	-------------

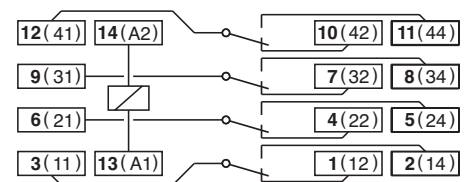
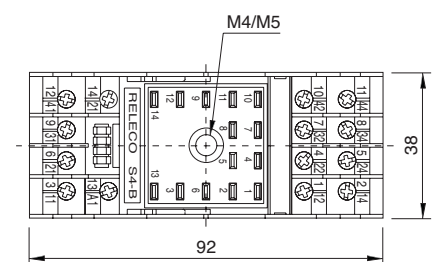
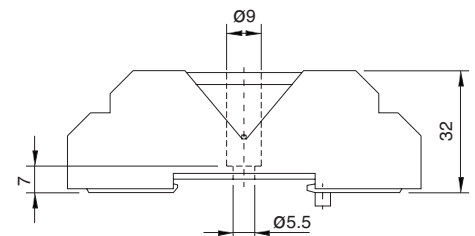
**Connection diagram****Dimensions [mm]****Technical approvals, conformities**

EN 60947, EN 61810



Kühn Controls AG

Notes:

You want more information about this product, please call us: tel: +49 (0)7082-940000 or send us a fax: +49 (0)7082-940001, or email: sales@kuehn-controls.de or visit our Website: www.kuehn-controls.de